

Tarmaroo Camp, Bluewater, Townsville

Home of Bluewater Scouts

Scale 1:4,000 (1cm = 40m) Contours 2m/10m

Metres 25 50 75 100



- Contour (2m); Index contour (10m)
- Earth bank: Low, High
- Rock face: Passable, Impassable
- Cave; Rocky pit; Bare Rock
- Stony ground; Sandy ground
- River, Lake: Impassable, Passable
- Waterhole; Bubbler/Tap
- Stream; Ditch; Narrow marsh
- Open land; Rough open land
- Bush: Run, Jog, Walk, Fight
- Notable tree; Stump or dead tree
- Out Of Bounds; Garden (do not enter)
- Dirt path: Indistinct, Narrow, Wide (Retaining) walls: Passable, Impassable
- Fences: Passable, Impassable
- Building (do not enter); Canopy
- High pole, Power pylon, Other object
- Road, Car park, Paved area with traffic
- Paved area without traffic; Step or edge; Stairs
- Construction, Hazardous areas (do not enter)

Map published by and Copyright Mark Roberts, Orienteering Queensland and Scouts Queensland.

Created February 2026 by Mark Roberts

0404 50 99 24 mark@markroberts.id.au

Orienteering is made possible by the kindness and cooperation of land owners and managers.

Please respect fences, gardens, out of bounds areas, residents, neighbours, visitors, wildlife and livestock.

Possession of this map does not confer the right to enter this area or organise any event on this area.

This version 6th May 2026 has not been groundtruthed.

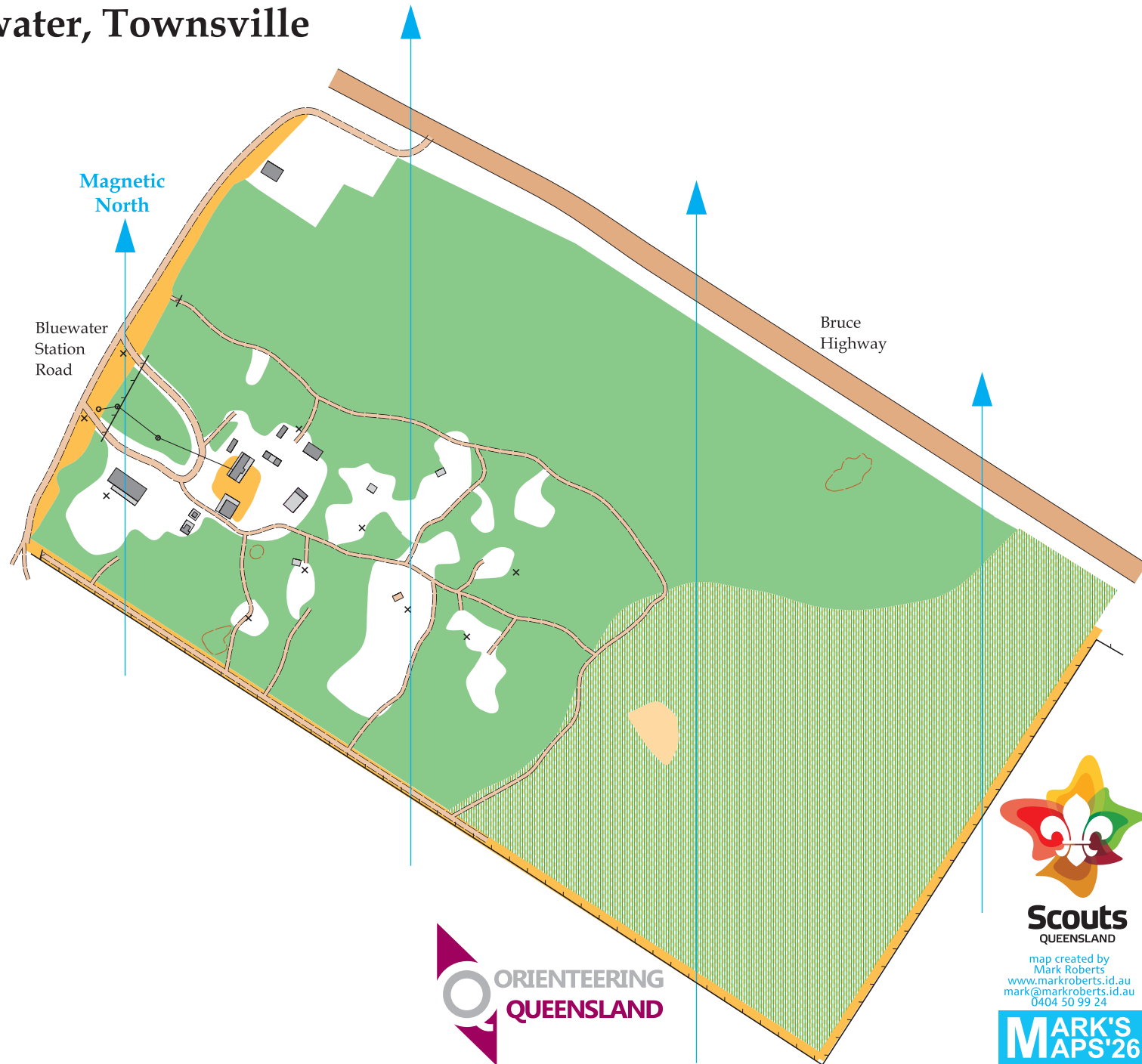

Scouts
QUEENSLAND

map created by
Mark Roberts
www.markroberts.id.au
mark@markroberts.id.au
0404 50 99 24

MARK'S
MAPS'26